

# Tips and tricks for assembling lasercut kits

## Choice of suitable adhesive

We generally recommend Express Wood Glue as the ideal glue for this Laser cut models. This high quality, solid-colored architectural cardboard can not be dissolved with express wood glue.

Express wood glue is significantly more adhesive than e.g. All Purpose Adhesive.

With Express wood glue, an adhesive time of 5-10 minutes is sufficient under weight or with parentheses.

## Assembly of the substructure

It's best to start with the biggest part of the flat building core, attach it to all other vertically arranged components.

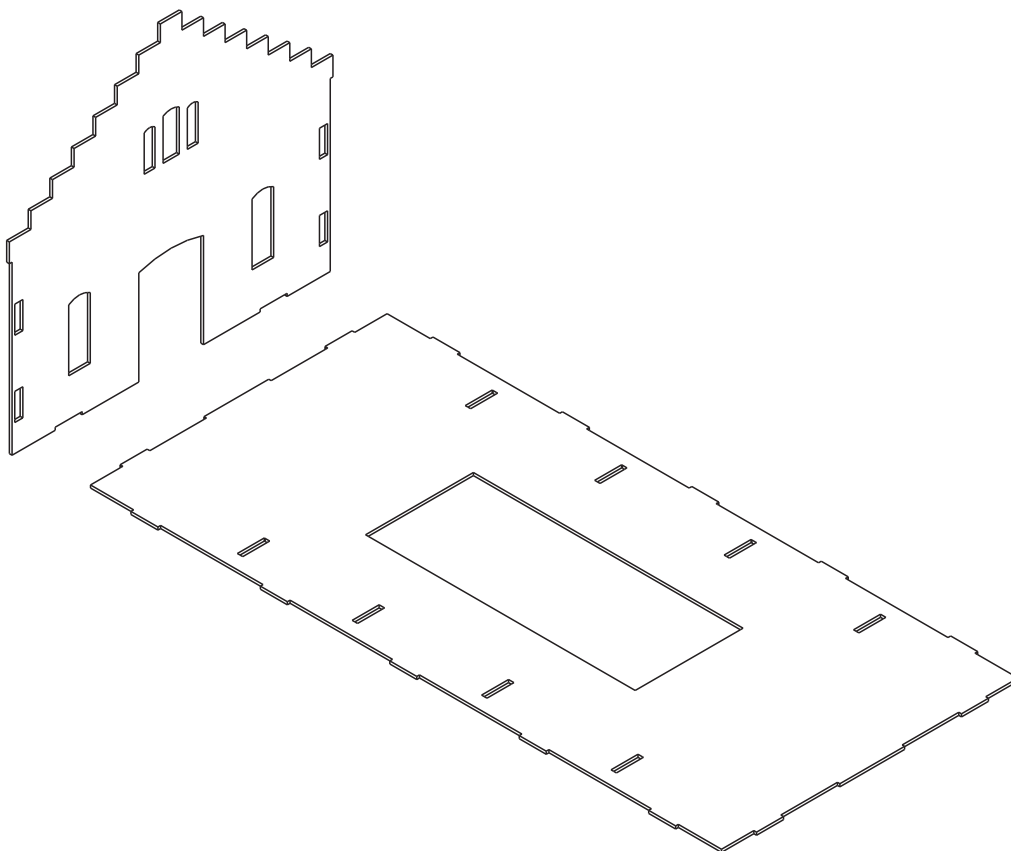

## Bonding of the first vertical core parts

Steelweights from hardware store or ironmongery help crosswalls support, a few minutes is enough. The first adhesive joints are the most important, because if these are too inaccurate, the rest of the building significantly less accurate.

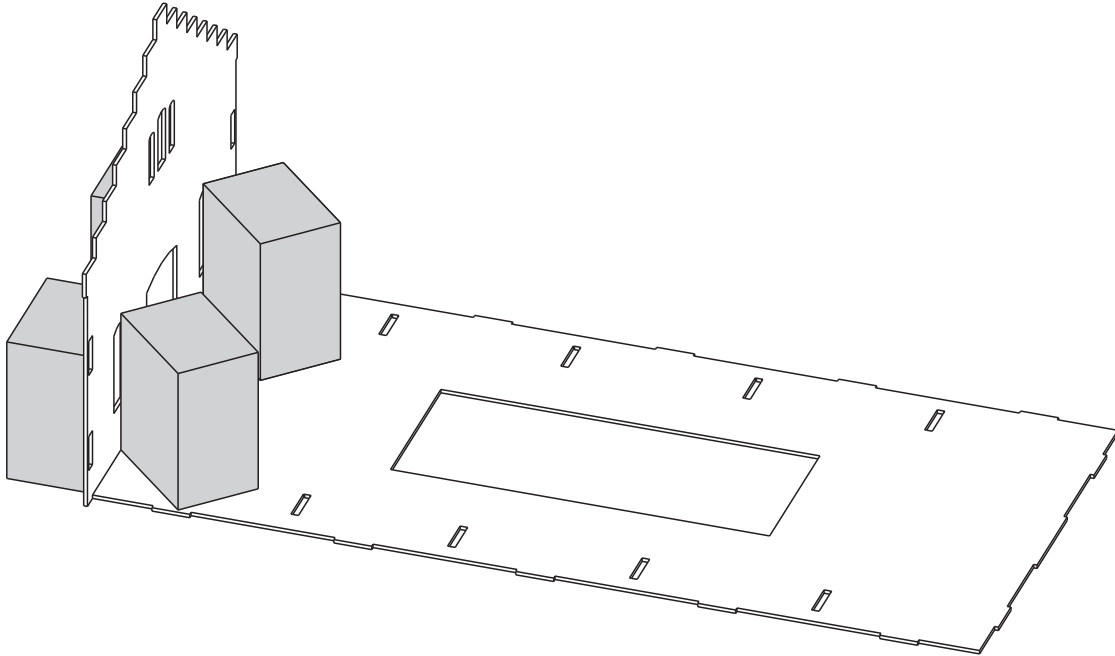

## Gluing the facades

Apply thin adhesive strips to the components, then e.g. with a cardboard piece like a spatula, this will overflow adhesive avoided. The adhesive film should still be wet on the outer edges of the components.

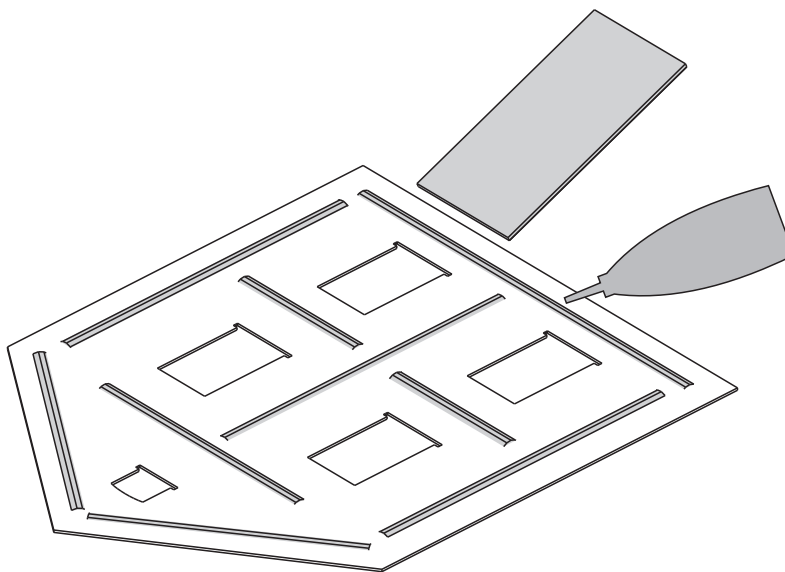

## Assembly sequence for the facades

First glue those facade sides to the core, which are flush with the core depending on the construction, it is the gable or the long side.

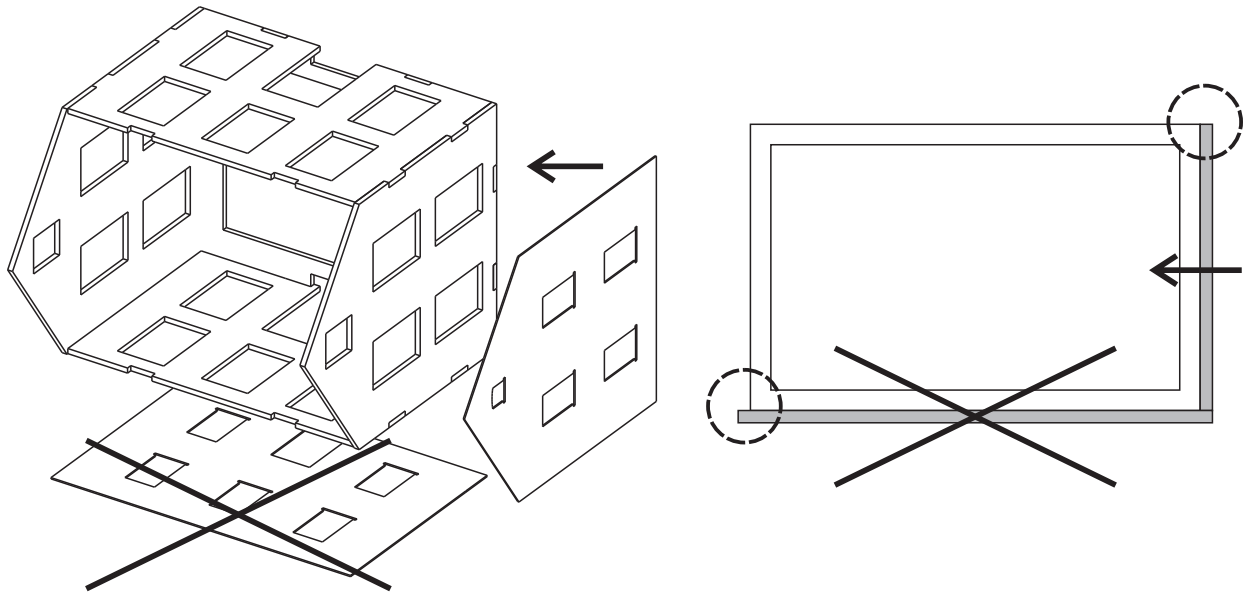

Arrange the weights for gluing the facades.

optimal: place weight (s) in the core, the side of the facade to be glued down  
place the pad.

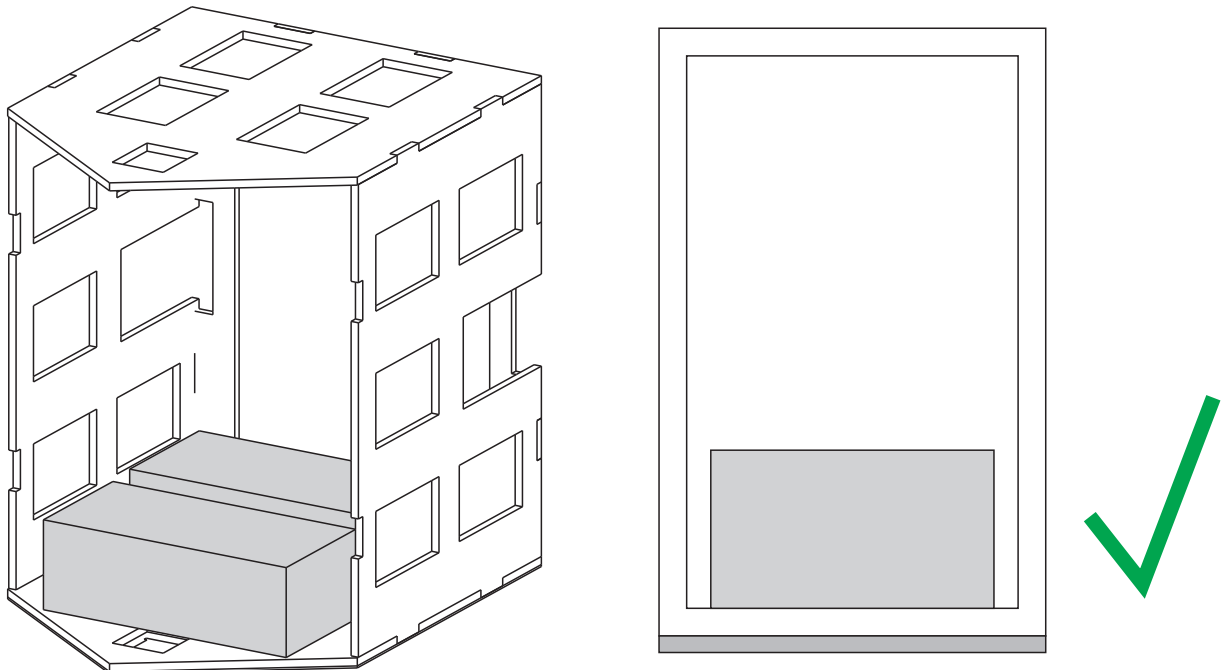

only partially suitable: if no weight can be placed inside, weights can also be placed on top of the core, but the core should be already firmly glued

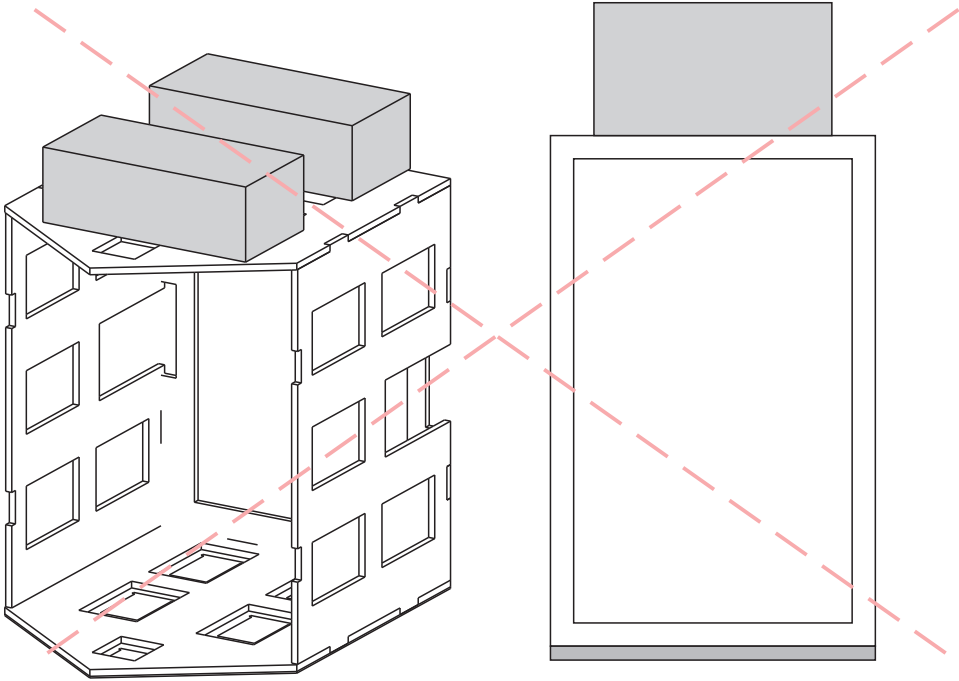

unfavorable: put weights on top of the facade, this may cause the bend component edges upwards

